

The purpose of this new application is to replace the existing Street Café Licence Number CAFE006.

We are asking for a variation to the licence terms to read:

10.0 The use of the Licenced Area shall cease before 22.00 hours each day and shall not commence prior to 07.00 hours.

In support of the changes to the term the business hosts various local groups which run late into the evening.

As with many other A3 businesses in Lancaster we do not have any miscellaneous storage areas. This means that whilst the business is open, the street furniture needs to be outside. Whilst the business opens at 08.00 hours Mon-Sat and 10.00 hours on Sundays, commencing the licence at 07.00 hours gives the staff the chance to set up fully before each day's trading.

If you have any questions regarding this application I can be contacted best by email on oli@juicafe.co.uk or mobile number 07780462467.

A handwritten signature in black ink, appearing to read "Oliver Wilson-Fish".

Oliver Wilson-Fish

General Manager

LANCASHIRE COUNTY COUNCIL

FOR OFFICE USE

Application No...

Date...

Fee Paid...

Receipt No...

Application for a Licence to use the Highway for a Street Café
Highways Act 1980 Section 115C-E

20 MAY 2015
268-90

Please read the notes and answer all the following questions

Question 1

Your Name and Address *OLIVER WILSON-FISH*
JULIAFE
53, MARKET STREET
LANCASTER

Postcode *LA1 1JG*
Tel. No. *01524880002*

Question 2

Name and address of any person acting for you

Not Applicable

Question 3

Describe the proposed location for the street café and address if different from the address in Q1 above.

As above.

Question 4

Please state the main proposed materials (for example: furniture, umbrellas, boundary markers, colour, type, styles) and show them on your detailed layout plan.

Tables, chairs, barriers, barrier posts.

Question 5

Do you intend to alter any of the building and/or building frontage to accommodate the proposal? If YES, please show details of the alterations on your plan.

YES/NO NO

Question 6

Are there any lighting columns, litter bins, road signs, public seating, trees, etc. on the site within the boundary of the area proposed for the street café?

If YES, please show them on your plan.

YES/NO NO

Question 7

Is proper sanitary accommodation available within the building to be used to service the Street café?

YES/NO NO

Question 8

Is it intended to seek a licence to serve alcohol within the street café area?

If YES, please answer Q9 below.

YES NO

Question 9

What range of drinks (alcoholic and non-alcoholic) is it intended will be served within the street café area?

Give details below. *Teas, Coffees, Hot Chocolates, smoothies, juices, bottled carbonated & still soft drinks.*

The applicant should be aware that the granting of a licence does not permit the sale of alcohol within the outdoor café area. Separate licensing arrangements apply for the sale of alcohol and the applicant should check the conditions on the Premises Licence or consult the Licensing Authority.

Question 10

Please read and sign the following statement.

I wish to apply for a licence to use the highway fronting the above named property for the purpose of a street café as described in this application and the accompanying plans and enclose the required fee.

Signed. *[Signature]*

Date. *11/3/15*

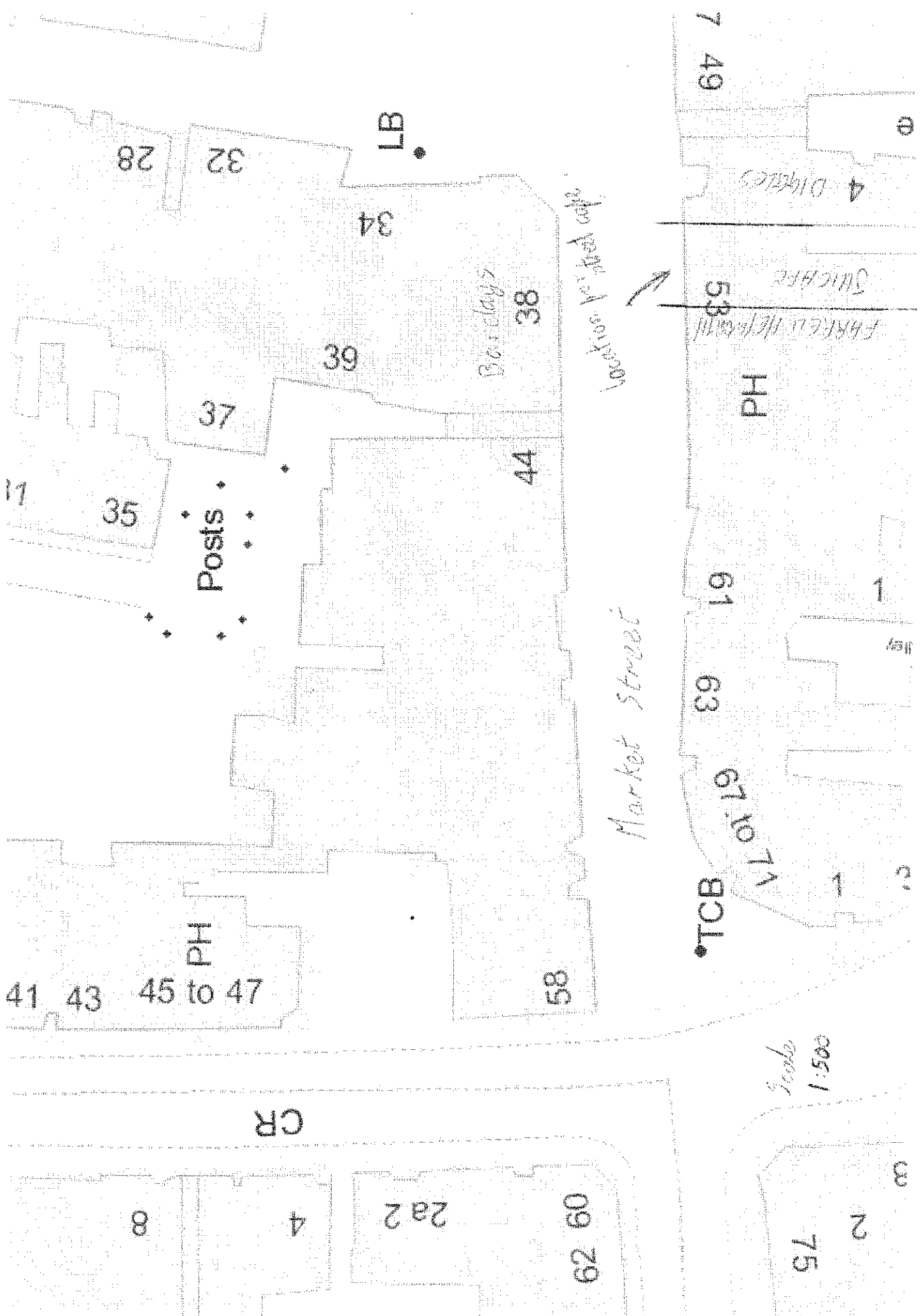

7 49

e

DITCHES

SUNSHINE

FARREN McFARREN

PH

1

High

61

63

67

71

TCL

2

Scale 1:500

3

2

75

BT

28

32

34

38

39

37

44

35

Posts

41

PH

41

43

45 to 47

58

CR

8

4

2a2

09 29

Market Street

Barclay

VOCATIONAL HIGH SCHOOL

6. Management arrangements for street cafe, 53, Market Street.

i/ Barriers and seating will be put out each morning prior to opening.

ii/ Staff will regularly check for tables to be cleared and cleaned throughout the day.

iii/ Barriers and seating will be taken inside at the close of trading each day.

iv/ The area encompassing the street cafe will be swept as needed throughout the day and at close of trading.

Diggles

no 53

Farrell Heyworth

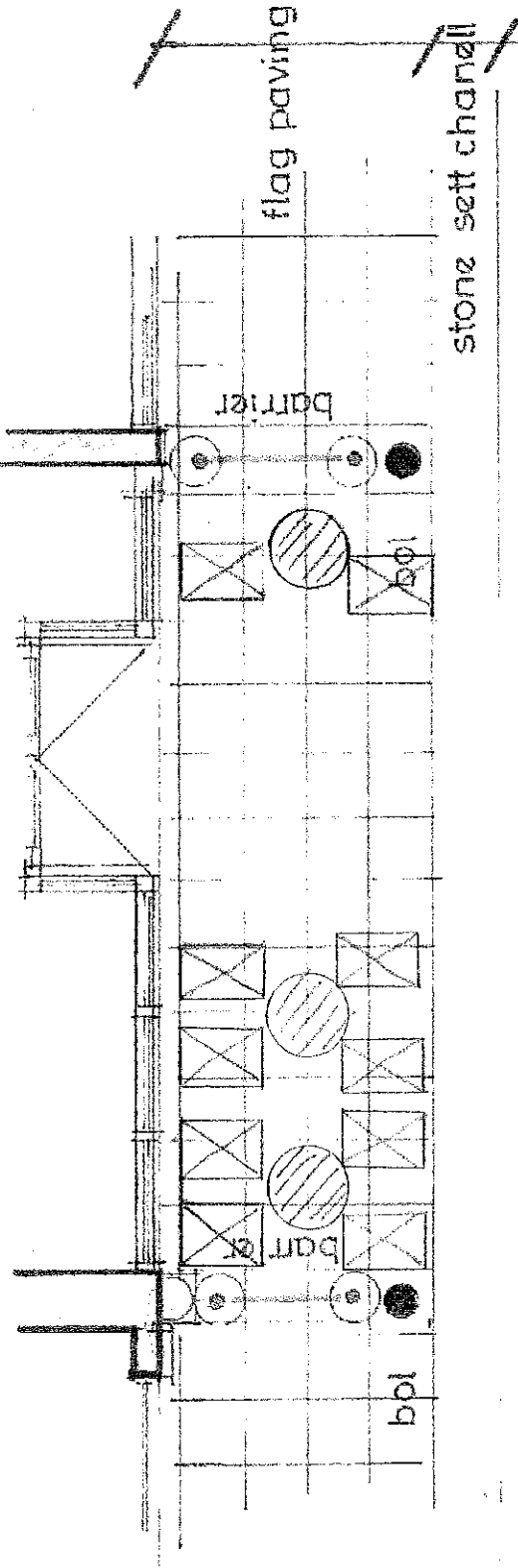

○ = Table

⊠ = Chair

market street

block paviers

Scale: 1/50

Company activity Please Choose... *

Estimated pieces Please Choose... *

Estimated timeframe Please Choose... *

Details about your current project: *

I'm interested in the KU CATALINA ARMCHAIR for...

Alternatively you can phone us on 0845 833 8125.

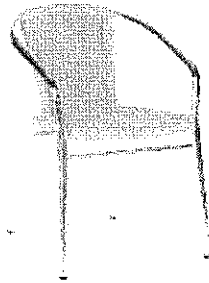

Stackable armchair, seat and back in weave,
available in the following colours:

Beige, Blue, Green, **Black**, Burgundy and Brown.

Frame in aluminium, suitable for outdoor use.

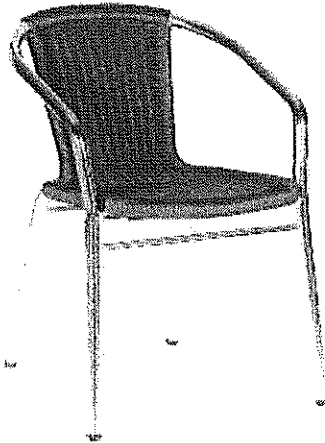

You may also be interested in some of the most respected and valued associations in the hospitality and leisure furniture search industries

The table bases incorporate FLAT echnology. It is a basic pnumatic system which ensures the tables are not wobbly regardless of the surface they are on. Much more important before the improvement works were done. The tables still remain steady on the new improved surface resulting in a reduced chance in customers spilling their purchases. For more info go to:

<http://www.buymodernhospitalityfurniture.com/flat-tech-table-bases>

